

MURRAY

MURRAY CORPORATION Clamping Solutions

Seamless Pinch Clamps (KVG T)

These "Tongue and Groove" clamps offer 360° seamless fastening. Due to their seamless design and uniform compression sealing, these clamps are often used in the beverage, automotive, marine, and motorcycle industries. They are manufactured using 304 Stainless Steel and are perfect for poly and braided tubing.

- Murray Seamless Pinch Clamps provide 360 degrees of contact with your hose to help eliminate leaks
- Made with 304 Stainless Steel for high corrosion resistance to excel in difficult conditions like marine applications
- Our patented Crimp Lobes and our improved ear geometry helps eliminate miscrimps by keeping your crimping tool in place while helping create a 360 degree seal that will increase the performance of the connection.
- Ideal for use with OEM and Aftermarket applications in many markets such as: Automotive, Marine, Heavy Duty Truck, Beverage, Medical and many others.

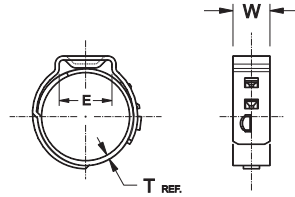

CLAMPS WITH OPEN DIA. (mm)	W (mm)	E (mm)	T (in)
7.0 - 11.8	5.0	5.5	.019
12.3 - 17.0	7.0	8.0	.022
18.5 - 66.0	7.0	10.0	.022



Many of our Seamless (KVG T) clamps offer our patented crimp lobe technology. This feature ensures that the crimping tool is properly positioned to help eliminate miscrimps which can result in leaks.

5 mm wide band

Part Number	Open Dia	Closed Dia
KVGT5056	5.6mm	4.4mm
KVGT5065	6.5mm	5.3mm
KVGT5070	7.0mm	5.8mm
KVGT5080	8.0mm	6.8mm
KVGT5087	8.7mm	7.0mm
KVGT5095	9.5mm	7.8mm
KVGT5100	10.0mm	8.3mm
KVGT5105	10.5mm	8.8mm
KVGT5109	10.9mm	9.2mm
KVGT5113	11.3mm	9.6mm
KVGT5118	11.8mm	10.1mm

7 mm wide band

Part Number	Open Dia	Closed Dia
KVGT7123	12.3mm	9.8mm
KVGT7133	13.3mm	10.8mm
KVGT7138	13.8mm	11.3mm
KVGT7140	14.0mm	11.5mm
KVGT7145	14.5mm	12.0mm
KVGT7153	15.3mm	12.8mm
KVGT7157	15.7mm	13.2mm
KVGT7162	16.2mm	13.7mm
KVGT7170	17.0mm	14.5mm
KVGT7180	18.0mm	15.5mm
KVGT7185	18.5mm	16.0mm
KVGT7192	19.2mm	16.0mm
KVGT7198	19.8mm	16.6mm
KVGT7210	21.0mm	17.8mm
KVGT7220	22.0mm	18.8mm
KVGT7226	22.6mm	19.4mm
KVGT7235	23.5mm	20.3mm
KVGT7241	24.1mm	20.9mm
KVGT7256	25.6mm	22.4mm
KVGT7271	27.1mm	23.9mm
KVGT7286	28.6mm	25.4mm
KVGT7455	45.5mm	42.3mm

* Patented crimp lobes are currently available on select sizes. Please contact us for details.

Automotive



Beverage



Marine



Heavy Duty Truck



260 Schilling Circle
Hunt Valley, MD, 21031, USA

Ph: 410-771-0380 • Fax: 410-771-5576
www.murraycorp.com
email: sales@murraycorp.com