

rtc[®]

QUICK CONNECT TECHNOLOGY
www.rtc-tec.com



090

rtc TYPE





European profile

Temperature Range - Temperaturbereich
-5°C +180°C (+41°F +356°F) FPM (V)

Working Pressure - Betriebsdruck

rtc 090.06 0 - 10 bar (0 - 145 PSI)
rtc 090.09 0 - 15 bar (0 - 217 PSI)
rtc 090.13 0 - 15 bar (0 - 217 PSI)

Flow size - Nennweiten

rtc 090.06 6 mm
rtc 090.09 9 mm
rtc 090.13 13 mm

Standard version - Standardversion

Brass - Messing
FPM (V) PTFE coated - Viton PTFE beschichtet

Material

Socket Body-
Kupplungsgrundkörper : Brass - Messing
Sleeve - Hülse : Brass - Messing
Valve - Ventil : Brass - Messing
Springs - Federn : Stainless steel - Edelstahl
Locking Ring - Sprengring : Stainless steel - Edelstahl
Balls - Kugeln : 18/8 Stainless steel - Edelstahl
Seals - Dichtungen : FPM (V)
Plug - Nippel : Brass - Messing

Options - Optionen

Stainless Steel - Edelstahl
Safety lock - Sicherheitsentriegelung

Using Area

- On temperature regulation applications with hot or cold water, oil etc
- Injection moulding industries
- On steam line

Anwendungsbereiche

- Werkzeugtemperierung
- Kühlung mit Öl oder Wasser
- Kunststoffindustrie
- Dampfanwendungen



Safety type coupler for disconnect protection
Sicherheitsfunktion für das ungewollte Trennen

Add "S" to item code / Fügen Sie "S" zur Artikelnummer hinzu

Flow Rate vs Pressure Drop Graph

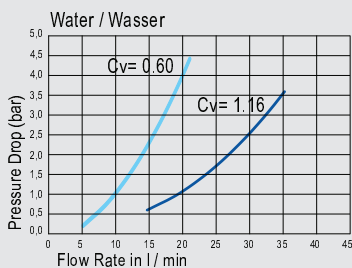

— 090.06 = Free passage 090.06 = Freier Durchgang
— 090.06 = Shut-off 090.06 = Absperrend

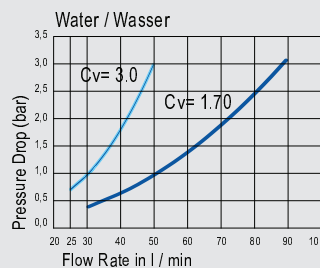

— 090.09 = Free passage 090.09 = Freier Durchgang
— 090.09 = Shut-off 090.09 = Absperrend

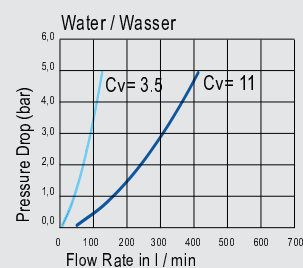

— 090.13 = Free passage 090.13 = Freier Durchgang
— 090.13 = Shut-off 090.13 = Absperrend

090
rtc TYPE

rtc TYPE 090

Standard hose tail socket / Kupplung mit gerader Standard - Schlauchtülle



Sockets / Kupplungen

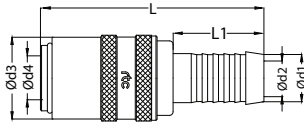

Size / Größe	Order No / Bestellnr. With Valve / Mit Ventil	Order No / Bestellnr. Without Valve / ohne Ventil	D1	D2	D3	D4	L	L1
6	090.06 SHB 06	090.06 SHF 06	6	5	17	9	53	22.5
6	090.06 SHB 09	090.06 SHF 09	9	6	17	9	53	22.5
6	090.06 SHB 13	090.06 SHF 13	13	9	17	9	55	25
9	090.09 SHB 09	090.09 SHF 09	9	8	22	13	61.5	25
9	090.09 SHB 13	090.09 SHF 13	13	9	22	13	61.5	25
13	090.13 SHB 19	090.13 SHF 19	19	13	31	19	93	32

rtc TYPE 090

Push to connect hose tail socket / Kupplung mit gerader Schnellsteck - Schlauchtülle



Sockets / Kupplungen

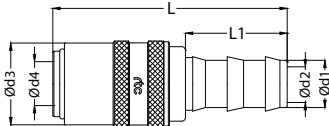

Size / Größe	Order No / Bestellnr. With Valve / Mit Ventil	Order No / Bestellnr. Without Valve / ohne Ventil	D1	D2	D3	D4	L	L1
6	090.06 SPB 10	090.06 SPF 10	10	6	17	9	59	24
9	090.09 SPB 10	090.09 SPF 10	10	8	22	13	65	24
9	090.09 SPB 13	090.09 SPF 13	13	9	22	13	65	28
13	090.13 SPB 16	090.13 SPF 16	16	13	31	19	96	38
13	090.13 SPB 19	090.13 SPF 19	19	13	31	19	96	38

rtc TYPE 090

Standard hose tail socket 45° / Kupplung mit 45° Standard - Schlauchtülle



Sockets / Kupplungen

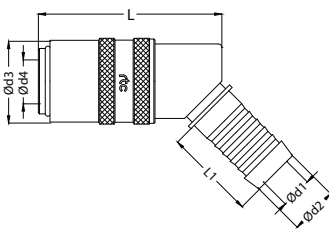

Size / Größe	Order No / Bestellnr. With Valve / Mit Ventil	Order No / Bestellnr. Without Valve / ohne Ventil	D1	D2	D3	D4	L	L1
6	090.06 SHB 06 45	090.06 SHF 06 45	6	5	17	9	43	22.5
6	090.06 SHB 09 45	090.06 SHF 09 45	9	6	17	9	43	22.5
9	090.09 SHB 09 45	090.09 SHF 09 45	9	8	22	13	51	25
9	090.09 SHB 13 45	090.09 SHF 13 45	13	9	22	13	51	25
13	090.13 SHB 19 45	090.13 SHF 19 45	19	13	31	19	78	32

rtc TYPE 090

Push to connect hose tail socket 45° / Kupplung mit 45° Schnellsteck - Schlauchtülle



Sockets / Kupplungen

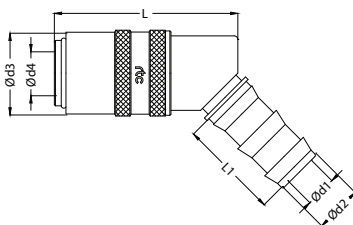

Size / Größe	Order No / Bestellnr. With Valve / Mit Ventil	Order No / Bestellnr. Without Valve / ohne Ventil	D1	D2	D3	D4	L	L1
6	090.06 SPB 10 45	090.06 SPF 10 45	10	6	17	9	43	24
9	090.09 SPB 10 45	090.09 SPF 10 45	10	8	22	13	51	24
9	090.09 SPB 13 45	090.09 SPF 13 45	13	9	22	13	51	28
13	090.13 SPB 19 45	090.13 SPF 19 45	19	13	31	19	78	38



Standard hose tail socket 90° / Kupplung mit 90° Standard - Schlauchtülle

TYPE 090 

Sockets / Kupplungen

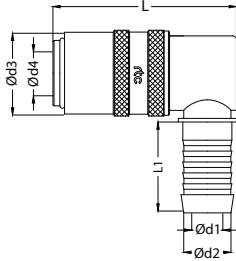

Size / Größe	Order No / Bestellnr. With Valve / Mit Ventil	Order No / Bestellnr. Without Valve / ohne Ventil	D1	D2	D3	D4	L	L1
6	090.06 SHB 06 90	090.06 SHF 06 90	6	5	17	9	43	22.5
6	090.06 SHB 09 90	090.06 SHF 09 90	9	6	17	9	43	22.5
9	090.09 SHB 09 90	090.09 SHF 09 90	9	8	22	13	51	30
9	090.09 SHB 13 90	090.09 SHF 13 90	13	9	22	13	51	30
13	090.13 SHB 19 90	090.13 SHF 19 90	19	13	31	19	78	32



Push to connect hose tail socket 90° / Kupplung mit 90° Schnellsteck - Schlauchtülle

TYPE 090 

Sockets / Kupplungen

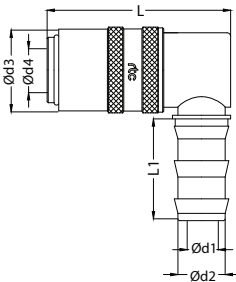

Size / Größe	Order No / Bestellnr. With Valve / Mit Ventil	Order No / Bestellnr. Without Valve / ohne Ventil	D1	D2	D3	D4	L	L1
6	090.06 SPB 10 90	090.06 SPF 10 90	10	6	17	9	43	33
9	090.09 SPB 10 90	090.09 SPF 10 90	10	8	22	13	51	33
9	090.09 SPB 13 90	090.09 SPF 13 90	13	9	22	13	51	33
13	090.13 SPB 19 90	090.13 SPF 19 90	19	13	31	19	78	38



Cylindrical male thread socket / Kupplung mit Aussengewinde zylindrisch

TYPE 090 

Sockets / Kupplungen

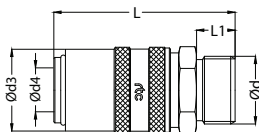

Size Größe	Order No / Bestellnr. With Valve / Mit Ventil	Order No / Bestellnr. Without Valve / ohne Ventil	D	D3	D4	L	L1	HEX.
6	090.06 SMB 13	090.06 SMF 13	BSP 1/4	17	9	48	9	17
6	090.06 SMB 17	090.06 SMF 17	BSP 3/8	17	9	48	9	19
6	090.06 SMB 1415	090.06 SMF 1415	M14x1.5	17	9	48	9	17
6	090.06 SMB 1615	090.06 SMF 1615	M16x1.5	17	9	48	9	19
9	090.09 SMB 13	090.09 SMF 13	BSP 1/4	22	13	52	9	22
9	090.09 SMB 17	090.09 SMF 17	BSP 3/8	22	13	52	9	22
9	090.09 SMB 21	090.09 SMF 21	BSP 1/2	22	13	52	10	24
9	090.09 SMB 1615	090.09 SMF 1615	M16x1.5	22	13	52	9	22
13	090.13 SMB 21	090.13 SMF 21	BSP 1/2	31	19	74	12	30
13	090.13 SMB 26	090.13 SMF 26	BSP 3/4	31	19	78	16	30
13	090.13 SMB 2415	090.13 SMF 2415	M24x1.5	31	19	78	16	30



Cylindrical male thread socket 45° / Kupplung mit 45° Aussengewinde zylindrisch

TYPE 090 

Sockets / Kupplungen

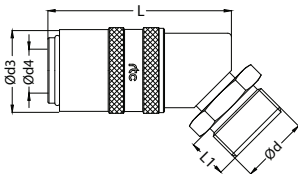

Size Größe	Order No / Bestellnr. With Valve / Mit Ventil	Order No / Bestellnr. Without Valve / ohne Ventil	D2	D3	D4	L	L1	HEX.
6	090.06 SMB 13 45	090.06 SMF 13 45	BSP 1/4	17	9	47	9	17
6	090.06 SMB 17 45	090.06 SMF 17 45	BSP 3/8	17	9	47	9	19
6	090.06 SMB 1415 45	090.06 SMF 1415 45	M14x1.5	17	9	47	9	17
6	090.06 SMB 1615 45	090.06 SMF 1615 45	M16x1.5	17	9	47	9	19
9	090.09 SMB 17 45	090.09 SMF 17 45	BSP 3/8	22	13	54	9	22
9	090.09 SMB 1615 45	090.09 SMF 1615 45	M16x1.5	22	13	54	9	22
13	090.13 SMB 2415 45	090.13 SMF 2415 45	M24x1.5	31	19	80	18	30

rtc TYPE 090

Cylindrical male thread socket 90° / Kupplung mit 90° Aussengewinde zylindrisch



Sockets / Kupplungen

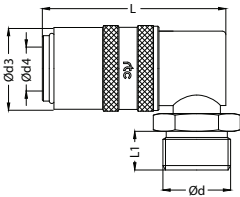

Size Größe	Order No / Bestellnr. With Valve / Mit Ventil	Order No / Bestellnr. Without Valve / ohne Ventil	D	D3	D4	L	L1	HEX.
6	090.06 SMB 13 90	090.06 SMF 13 90	BSP 1/4	17	9	47	9	17
6	090.06 SMB 17 90	090.06 SMF 17 90	BSP 3/8	17	9	47	9	19
6	090.06 SMB 1415 90	090.06 SMF 1415 90	M14x1.5	17	9	47	9	17
6	090.06 SMB 1615 90	090.06 SMF 1615 90	M16x1.5	17	9	47	9	19
9	090.09 SMB 17 90	090.09 SMF 17 90	BSP 3/8	22	13	54	9	22
9	090.09 SMB 1615 90	090.09 SMF 1615 90	M16x1.5	22	13	54	9	22
13	090.13 SMB 2415 90	090.13 SMF 2415 90	M24x1.5	31	19	80	18	30

rtc TYPE 090

Cylindrical female thread socket / Kupplung mit Innengewinde zylindrisch



Sockets / Kupplungen

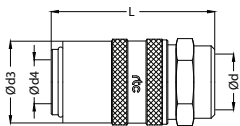

Size Größe	Order No / Bestellnr. With Valve / Mit Ventil	Order No / Bestellnr. Without Valve / ohne Ventil	D	D3	D4	L	HEX.
6	090.06 SFB 13	090.06 SFF 13	BSP 1/4	17	9	42	17
6	090.06 SFB 17	090.06 SFF 17	BSP 3/8	17	9	42	21
6	090.06 SFB 1415	090.06 SFF 1415	M14x1.5	17	9	42	17
9	090.09 SFB 13	090.09 SFF 13	BSP 1/4	22	13	45	22
9	090.09 SFB 17	090.09 SFF 17	BSP 3/8	22	13	46	22
9	090.09 SFB 21	090.09 SFF 21	BSP 1/2	22	13	49	22
9	090.09 SFB 1615	090.09 SFF 1615	M16x1.5	22	13	49	22
13	090.13 SFB 26	090.13 SFF 26	BSP 3/4	31	19	78	33

rtc TYPE 090

Cylindrical male thread socket short version / Kupplung mit Aussengewinde zylindrisch kurze Version



Sockets / Kupplungen

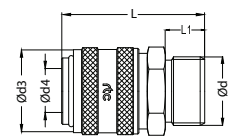

Size Größe	Order No / Bestellnr. Without Valve / Ohne Ventil	D	D3	D4	L	L1	HEX.
6	090.06 SMB 13x38	BSP 1/4	17	9	38	9	17
9	090.09 SMB 17x38	BSP 3/8	22	13	38	9	21

rtc TYPE 090

Diverting sockets / Umlenkkupplung



Sockets / Kupplungen

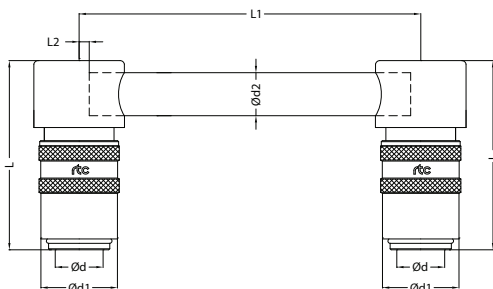

Size Größe	Order No / Bestellnr. Without Valve / Ohne Ventil	D	D1	D2	L	L1	L2
6	090.06 SCF 125	9	17	8x1	44	125	2
6	090.06 SCF 250	9	17	8x1	44	250	2
6	090.06 SCF 500	9	17	8x1	44	500	2
9	090.09 SCF 125	13	22	10x1	51	125	2
9	090.09 SCF 250	13	22	10x1	51	250	2
9	090.09 SCF 500	13	22	10x1	51	500	2
13	090.13 SCF 160	19	34	14x1	80	160	3
13	090.13 SCF 315	19	34	14x1	80	315	3
13	090.13 SCF 500	19	34	14x1	80	500	3

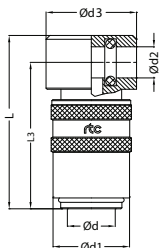

Size Größe	Order No / Bestellnr. Without Valve / Ohne Ventil	D	D1	D2	D3	L	L1
6	090.06 SCF 00	9	17	8x1	20	44	37
9	090.09 SCF 00	13	22	10x1	26	51	42
13	090.13 SCF 00	19	34	14x1	36	80	67

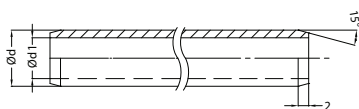

Pipe preparation / Verbindungsrohr

Brass Tube Messing Rohr	D	D1	Length Länge
TBM 0810x1000	8	6	1000mm
TBM 1010x1000	10	8	1000mm
TBM 1410x1000	14	12	1000mm



Adapting Socket with plug / Adapterkupplung mit Nippel

TYPE 090 

Sockets and Plugs / Kupplung und Nippel

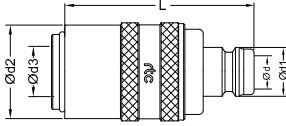

Order No / Bestellnr. With Valve / Mit Ventil	Order No / Bestellnr. Without Valve / Ohne Ventil	Plug Size Nippel Größe (D)	D1	D2	Socket Size Kupplung Größe (D3)	L	Passage
090.06 SXB 090.06	090.06 SXF 090.06	6	9	17	9	45	6
090.06 SXB 090.09	090.06 SXF 090.09	9	13	17	9	45	6
090.09 SXB 090.06	090.09 SXF 090.06	6	9	22	13	50.5	6
090.09 SXB 090.09	090.09 SXF 090.09	9	13	22	13	50.5	9

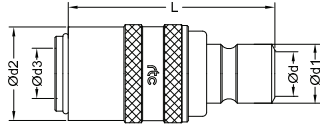

090.06 SXB 099.06	090.06 SXF 099.06	6	9.5	17	9	47.5	6
090.06 SXB 099.09	090.06 SXF 099.09	9	13.5	17	9	47.5	6
090.09 SXB 099.06	090.09 SXF 099.06	6	9.5	22	13	52	6
090.09 SXB 099.09	090.09 SXF 099.09	9	13.5	22	13	52	9



Blank end socket / Blindkupplung

TYPE 090 

Sockets / Kupplungen

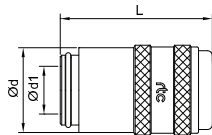

Order No / Bestellnr.	Body Size Größe (D)	D1	L
090.06 PL 00	6	17	30
090.09 PL 00	9	22	37
090.13 PL 00	13	31	58



Adapting Plug / Adapternippel

TYPE 090 

Plugs / Nippel

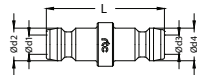

Order No / Bestellnr.	D1	D2	D3	D4	L
090.06 PXP 090.06	6	9.5	6	9.5	34

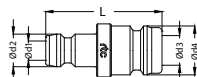

090.06 PXP 090.09	6	9.5	9	13	34
-------------------	---	-----	---	----	----



090.09 PXP 090.09	9	13	9	13	34
-------------------	---	----	---	----	----

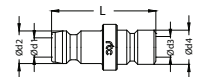

090.09 PXP 099.06	9	13	6	9.5	29
-------------------	---	----	---	-----	----

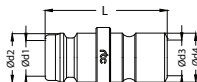

090.09 PXP 099.09	9	13	9	13.5	36
-------------------	---	----	---	------	----



Stop Plug / Blindnippel

TYPE 090 

Plugs / Nippel

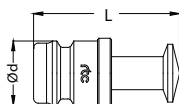

Order No / Bestellnr.	Body Size Größe	D	L
090.06 SL 00	6	9	28
090.09 SL 00	9	13	30
090.13 SL 00	13	19	52

rtc TYPE 090

Standard hose tail plug / Nippel mit gerader Standard - Schlauchtülle



Plugs / Nippel

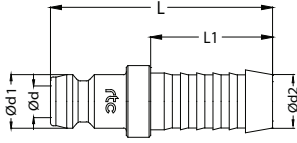

Order No / Bestellnr.	Body Size Größe (D)	D1	D2	L	L1
090.06 PHF 06	6	9	6	39.5	22.5
090.06 PHF 09	6	9	9	39.5	22.5
090.06 PHF 13	6	9	13	39.5	22.5
090.09 PHF 09	9	13	9	39.5	22.5
090.09 PHF 13	9	13	13	42	25
090.13 PHF 16	13	19	16	67	32
090.13 PHF 19	13	19	19	67	32

rtc TYPE 090

Push to connect hose tail plug / Nippel mit gerader Schnellsteck - Schlauchtülle



Plugs / Nippel

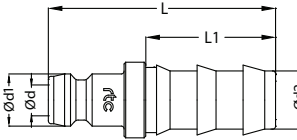

Order No / Bestellnr.	Body Size Größe (D)	D1	D2	L	L1
090.06 PPF 10	6	9	10	42	28
090.09 PPF 10	9	13	10	43	28
090.09 PPF 13	9	13	13	47	28
090.13 PPF 16	13	19	16	68	38
090.13 PPF 19	13	19	19	68	38

rtc TYPE 090.06

Cylindrical male thread plug / Nippel mit Aussengewinde zylindrisch



Plugs / Nippel

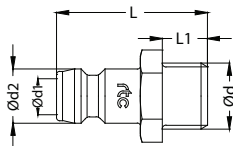

Order No / Bestellnr.	D	D1	D2	L	L1	HEX.
090.06 PMF 10	BSP 1/8	6	9	24	7	11
090.06 PMF 13	BSP 1/4	6	9	26	9	14
090.06 PMF 17	BSP 3/8	6	9	26	9	17
090.06 PMF 1010	M10x1	6	9	24	7	11
090.06 PMF 1415	M14x1.5	6	9	26	9	15
090.06 PMF 1615	M16x1.5	6	9	26	9	17

rtc TYPE 090.09

Cylindrical male thread plug / Nippel mit Aussengewinde zylindrisch



Plugs / Nippel

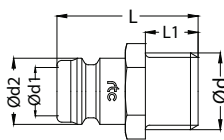

Order No / Bestellnr.	D	D1	D2	L	L1	HEX.
090.09 PMF 10	BSP 1/8	9	13	24	7	14
090.09 PMF 13	BSP 1/4	9	13	26	9	14
090.09 PMF 17	BSP 3/8	9	13	26	9	17
090.09 PMF 21	BSP 1/2	9	13	24	12	22
090.09 PMF 1010	M10x1	9	13	24	7	14
090.09 PMF 1415	M14x1.5	9	13	26	9	15
090.09 PMF 1615	M16x1.5	9	13	26	9	17

rtc TYPE 090.13

Cylindrical male thread plug / Nippel mit Aussengewinde zylindrisch



Plugs / Nippel

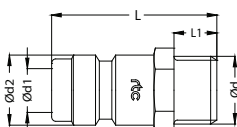

Order No / Bestellnr.	D	D1	D2	L	L1	HEX.
090.13 PMF 21	BSP 1/2	13	19	47	12	22
090.13 PMF 26	BSP 3/4	13	19	51	16	27
090.13 PMF 2415	M24x1.5	13	19	51	16	27



Cylindrical male thread plug inner hex. / Nippel mit Aussengewinde zylindrisch Innensechskant

TYPE 090.06



Plugs / Nippel

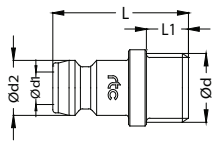

Order No / Bestellnr.	D	D1	D2	L	L1	HEX.
090.06 PMFH 10	BSP 1/8	6	9	24	7	5
090.06 PMFH 13	BSP 1/4	6	9	27	9	5
090.06 PMFH 0875	M8x075	6	9	24	9	5
090.06 PMFH 1010	M10x1	6	9	24	9	5
090.06 PMFH 1415	M14x1.5	6	9	27	9	5



Cylindrical male thread plug inner hex. / Nippel mit Aussengewinde zylindrisch Innensechskant

TYPE 090.09



Plugs / Nippel

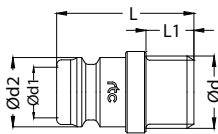

Order No / Bestellnr.	D	D1	D2	L	L1	HEX.
090.09 PMFH 13	BSP 1/4	9	13	26	9	8
090.09 PMFH 17	BSP 3/8	9	13	26	9	8
090.09 PMFH 1415	M14x1.5	9	13	26	9	8



Cylindrical female thread plug / Nippel mit Innengewinde zylindrisch

TYPE 090.06



Plugs / Nippel

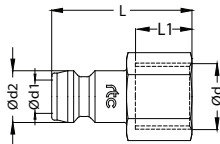

Order No / Bestellnr.	D	D1	D2	L	L1	HEX.
090.06 PFF 10	BSP 1/8	6	9	25	7	14
090.06 PFF 13	BSP 1/4	6	9	27	9	17
090.06 PFF 17	BSP 3/8	6	9	27	9	19



Cylindrical female thread plug / Nippel mit Innengewinde zylindrisch

TYPE 090.09



Plugs / Nippel

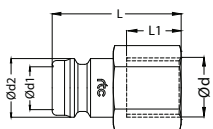

Order No / Bestellnr.	D	D1	D2	L	L1	HEX.
090.09 PFF 17	BSP 3/8	9	13	25	9	19
090.09 PFF 21	BSP 1/2	9	13	28	12	24



Cylindrical male thread plug with valve / Verschlussnippel mit Aussengewinde zylindrisch

TYPE 090.06



Plugs / Nippel

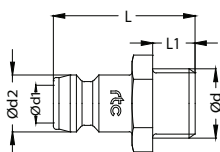

Order No / Bestellnr.	D	D1	D2	L	L1	HEX.
090.06 PMB 13	BSP 1/4	6	13	29	9	14
090.06 PMB 17	BSP 3/8	9	13	29	9	17
090.06 PMB 1415	M14x1.5	6	13	29	9	15

rtc TYPE 090.09 Cylindrical male thread plug with valve / Verschlussnippel mit Aussengewinde zylindrisch

Plugs / Nippel

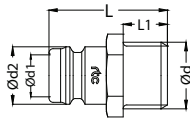

Order No / Bestellnr.	D	D1	D2	L	L1	HEX.
090.09 PMB 13	BSP 1/4	9	13	29	9	14
090.09 PMB 17	BSP 3/8	9	13	29	9	17
090.09 PMB 21	BSP 1/2	9	13	29	9	22
090.09 PMB 1415	M14x1.5	9	13	29	9	15
090.09 PMB 1615	M16x1.5	9	13	29	9	17

rtc TYPE 090.13 Cylindrical male thread plug with valve / Verschlussnippel mit Aussengewinde zylindrisch

Plugs / Nippel

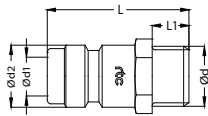

Order No / Bestellnr.	D	D1	D2	L	L1	HEX.
090.13 PMB 21	BSP 1/2	13	19	47	12	22
090.13 PMB 26	BSP 3/4	13	19	51	16	27
090.13 PMB 2415	M24x1.5	13	19	51	16	27

rtc TYPE 090.06 Male thread plug 90° / Nippel mit Aussengewinde (Metric DIN 158 - Conical DIN 2999)

Plugs / Nippel

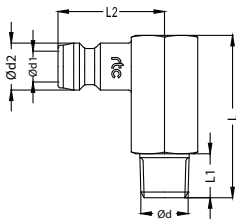

Order No / Bestellnr.	D	D1	D2	L	L1	L2	HEX.
090.06 PRF 10 90	BSPT 1/8	6	9	27	9	23	11
090.06 PRF 13 90	BSPT 1/4	6	9	29	11	23	15
090.06 PKF 0875 90	M8x075	6	9	27	9	23	11
090.06 PKF 1010 90	M10x1	6	9	27	9	23	11
090.06 PKF 1415 90	M14x1.5	6	9	29	11	23	15

rtc TYPE 090.09 Male thread plug 90° / Nippel mit Aussengewinde (Metric DIN 158 - Conical DIN 2999)

Plugs / Nippel

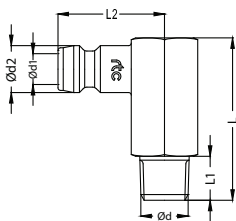

Order No / Bestellnr.	D	D1	D2	L	L1	L2	HEX.
090.09 PRF 13 90	BSPT 1/4	9	13	34	11	25	15
090.09 PRF 17 90	BSPT 3/8	9	13	34	11	25	17
090.09 PKF 1415 90	M14x1.5	9	13	34	11	25	15

rtc TYPE 090.13 Male thread plug 90° / Nippel mit Aussengewinde (Metric DIN 158 - Conical DIN 2999)

Plugs / Nippel

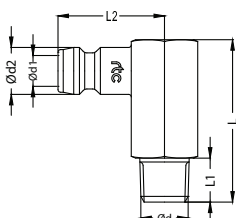

Order No / Bestellnr.	D	D1	D2	L	L1	L2	HEX.
090.13 PRF 21 90	BSPT 1/2	13	19	34	16	42	24
090.13 PRF 2415 90	M24x1.5	13	19	34	16	42	24



Male long thread plug / Nippel mit langem Aussengewinde zylindrisch

TYPE 090.06 **rtc**

Plugs / Nippel

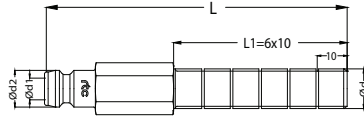

Order No / Bestellnr.	D	D1	D2	L	L1	HEX.
090.06 PMFL 10x100	BSP 1/8	6	9	100	6x10	11
090.06 PMFL 13x100	BSP 1/4	6	9	100	6x10	14
090.06 PMFL 17x100	BSP 3/8	6	9	100	6x10	17
090.06 PMFL 1010x100	M10x1	6	9	100	6x10	11
090.06 PMFL 1415x100	M14x1.5	6	9	100	6x10	14



Male long thread plug / Nippel mit langem Aussengewinde zylindrisch

TYPE 090.09 **rtc**

Plugs / Nippel

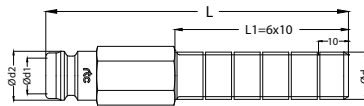

Order No / Bestellnr.	D	D1	D2	L	L1	HEX.
090.09 PMFL 13x100	BSP 1/4	9	13	100	6x10	14
090.09 PMFL 17x100	BSP 3/8	9	13	100	6x10	17
090.09 PMFL 1415x100	M14x1.5	9	13	100	6x10	14
090.09 PMFL 1615x100	M16x1.5	9	13	100	6x10	17



Plug extension / Nippelverlängerung

TYPE 090.06 **rtc**

Plugs / Nippel

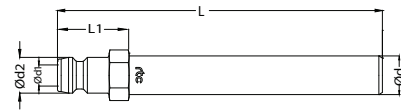

Order No / Bestellnr.	D	D1	D2	L	L1	HEX.
090.06 PEF 63	08	6	9	63	21	11
090.06 PEF 100	08	6	9	100	21	11
090.06 PEF 120	08	6	9	120	21	11
090.06 PEF 240	08	6	9	240	21	11
090.06 PEF 360	08	6	9	360	21	11



Plug extension / Nippelverlängerung

TYPE 090.09 **rtc**

Plugs / Nippel

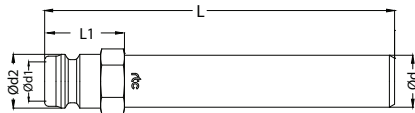

Order No / Bestellnr.	D	D1	D2	L	L1	HEX.
090.09 PEF 150-10	10	9	13	150	22	14
090.09 PEF 150	14	9	13	150	22	14
090.09 PEF 300	14	9	13	300	22	14
090.09 PEF 450	14	9	13	450	22	14



Plug extension / Nippelverlängerung

TYPE 090.13 **rtc**

Plugs / Nippel

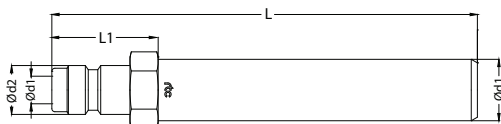

Order No / Bestellnr.	D	D1	D2	L	L1	HEX.
090.13 PEF 500	21	13	19	500	35	22
090.13 PEF 800	21	13	19	800	35	22

rtc TYPE 090 Extension for valved plug / Dichtungsrippel mit Verlängerung

Adapter / Nippel	Order No / Bestellnr.	D	D1	D2	L	L1	HEX.
	NFE 1415-120	M14x1.5	10	6	120	12	17
	NFE 1615-150	M16x1.5	14	9	150	12	22

rtc TYPE 090 Extension hose stems / Schlauchtülleverlängerung

Adapter / Nippel	Order No / Bestellnr.	D	D1	D2	L	L1	HEX.
	FHE 9-120 HT2	10	9	6	120	22.5	11
	FHE 13-150 HT2	14	13	9	150	25	15

rtc TYPE 090 Female thread standard hose connection / Innengewinde Schlauchtülle

Adapter / Nippel	Order No / Bestellnr.	ØD	D1	D2	L	L1	HEX.
	FHN 1415-09 HT2	M14x1.5	9	6	37.5	22.5	17
	FHN 1615-13 HT2	M16x1.5	13	9	40	22.5	21
	FHN 2415-19 HT2	M24x1.5	19	13	55	32	30

rtc TYPE 090 Standart hose connection with outer cone DIN 3863 and hex nut / Standard Schlauchtülle mit Überwurfmutter - Nippel mit Außenkonus DIN 3863

Adapter / Nippel	Order No / Bestellnr.	ØD	D1	D2	L	L1	HEX.
	FHNN 13-09 HT2	BSP 1/4	9	6	40	22.5	17
	FHNN 17-13 HT2	BSP 3/8	13	9	41	22.5	21
	FHNN 26-19 HT2	BSP 3/4	19	13	52	32	32
	FHNN 1415-09 HT2	M14x1.5	9	6	40	22.5	17
	FHNN 1615-13 HT2	M16x1.5	13	9	41	22.5	21
	FHNN 2415-19 HT2	M24x1.5	19	13	52	32	30

rtc TYPE 090 Male thred standart hose connection with collar / Außengewinde Standard Schlauchtülle mit Kragen

Adapter / Nippel	Order No / Bestellnr.	ØD	D1	D2	L	L1	L2	HEX.
	MHN 10-09/40 HT-2	BSP 1/8	9	6	40	22.5	14	11
	MHN 13-13/47 HT-2	BSP 1/4	13	8	47	22.5	16	15
	MHN 21-19/62 HT-2	BSP 1/2	19	13	62	35	22	22
	MHN 26-19/62 HT-2	BSP 3/4	19	13	62	35	22	27
	MHN 1010-09/40 HT-2	M10x1	9	6	40	22.5	14	11
	MHN 1215-13/47 HT-2	M12x1.5	13	7	47	25	16	15
	MHN 1415-13/47 HT-2	M14x1.5	13	9	47	25	16	15
	MHN 2415-19/62 HT-2	M24x1.5	19	13	62	35	22	27



Elbow Nippel 90° / Winkelnippel 90°

TYPE 090



Adapter / Nippel

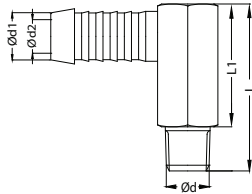

Order No / Bestellnr.	ØD	D1	D2	L	L1	HEX.
MHN 10-09 HT-2 90	BSPT 1/8	9	6	27	20	15
MHN 13-13 HT-2 90	BSPT 1/4	13	9	34	24	17
MHN 21-19 HT-2 90	BSPT 1/2	19	13	47	32	24
MHN 0875-09 HT-2 90	M8x0.75	9	4.5	27	20	15
MHN 1010-09 HT-2 90	M10x1	9	6	27	20	15
MHN 1415-13 HT-2 90	M14x1.5	13	9	34	24	17
MHN 2415-19 HT-2 90	M24x1.5	19	13	47	32	24



Replacement seal set / Ersatz O-Ring Set

TYPE 090



Seals / O-Ringe



Order No / Bestellnr.	Type	Material	Working Temp.
SS 090.06 N	6	NBR	-10°C - 100°C
SS 090.09 N	9	NBR	-10°C - 100°C
SS 090.13 N	13	NBR	-10°C - 100°C
SS 090.06 V	6	FKM	-5°C - 200°C
SS 090.09 V	9	FKM	-5°C - 200°C
SS 090.13 V	13	FKM	-5°C - 200°C