



# rtc<sup>®</sup>

QUICK CONNECT TECHNOLOGY  
[www.rtc-tec.com](http://www.rtc-tec.com)



# 127

rtc TYPE





Temperature Range - Temperaturbereich

-20°C +100°C (-4°F +212°F ) Nitril (N)  
 -10°C +180°C (+14°F +356°F ) FPM (V)  
 -20°C +150°C (-4°F +302°F ) EPDM (E)

Max. Working Pressure - Max. Betriebsdruck

rtc 127.37 10 bar (145 PSI)

Flow size - Nennweiten

rtc 127.37 37 mm

Standard version - Standardversion

Nitrile (NBR)

Options - Optionen

Fluorocarbene - FPM (V)  
 EPDM: (E)

Material

Coupler Body -  
 Kupplungsgrundkörper  
 Sleeve - Hülse  
 Valve - Ventil  
 Springs - Federn  
 Balls - Kugeln  
 Seals - Dichtungen  
 Plug - Nippel

Brass Nickel Plated -  
 Messing vernickelt  
 Steel - Stahl AISI 420  
 Stainless Steel - Edelstahl  
 Stainless Steel - Edelstahl  
 Stainless Steel - Edelstahl  
 Nitrile NBR (Ni)  
 Brass Nickel Plated -  
 Messing vernickelt



Flow Rate vs Pressure Drop Graph / Durchflussrate vs Druckabfall

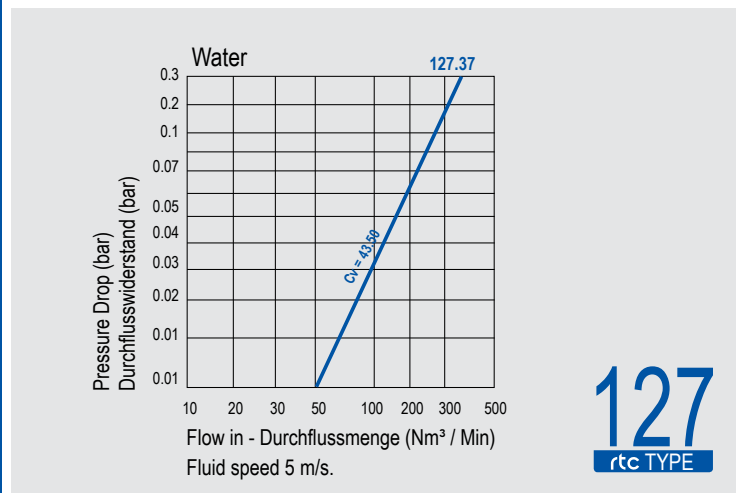

**127**  
rtc TYPE

**rtc** TYPE 127

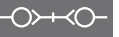

Socket / Kupplung

Size Größe	Connection (Ød)	Order No / Bestellnr.	Ød1 (mm)	L (mm)	HEX.
37	BSP 2	127.37 SFB 60	39	138	77
37	NPT 2	127.37 SNB 60	39	138	77
37	UNF 2-1/2-12	127.37 SUB 63	39	138	77

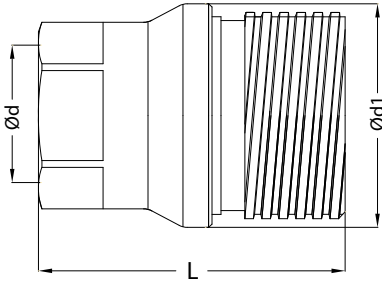

**rtc** TYPE 127



Plug / Nippel

Size Größe	Connection (Ød)	Order No / Bestellnr.	Ød1 (mm)	L (mm)	HEX.
37	BSP 2	127.37 PFB 60	39	138	77
37	NPT 2	127.37 PNB 60	39	138	77
37	UNF 2-1/2-12	127.37 PUB 63	39	138	77

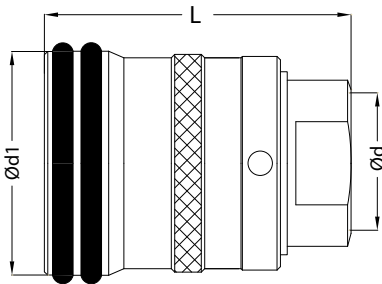

**rtc** TYPE 127

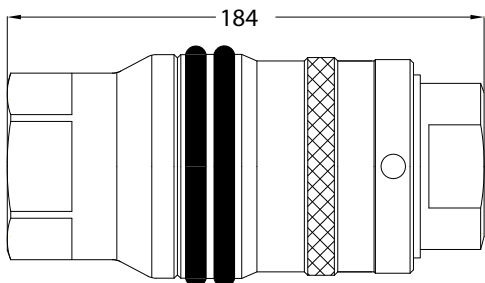

Size Größe	Brass Messing	Steel Stahl	Stainless Steel / Edelstahl (AISI 303 / AISI 316)
BSP 2	30 bar	95 bar	90 bar

# MULTI CONNECT TECHNOLOGY



[www.rtc-tec.com](http://www.rtc-tec.com)

# QUICK CONNECT TECHNOLOGY



Water

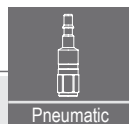

Pneumatic



Hydraulic

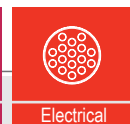

Electrical



Accessories