



rtc[®]

QUICK CONNECT TECHNOLOGY
www.rtc-tec.com



101

rtc TYPE





Standard version - Standardversion

Brass - Messing
FPM (V)

Options - Optionen

Stainless Steel - Edelstahl
EPDM Seal - EPDM Dichtung
FFKM Seal - FFKM Dichtung
Colour coding - Farbkodierung

Using Area

- On temperature regulation applications with hot or cold water, oil etc
- Injection moulding industries
- On steam line

Anwendungsbereiche

- Werkzeugtemperierung
- Kühlung mit Öl oder Wasser
- Kunststoffindustrie
- Dampfanwendungen

Material

Coupler Body-
Kupplungsgrundkörper Brass - Messing
Sleeve - Hülse AISI 420 Chroma plated
Valve - Ventil Brass - Messing
Springs - Federn Stainless Steel - Edelstahl

Seals - Dichtungen FPM (V)

Plug - Nippel
101.06 / 101.09 / 101.10 / 101.12 Brass - Messing
101.16 / 101.20 / 101.25 / 101.38 Stainless Steel - Edelstahl

Temperature Range - Temperaturbereich

-20°C +100°C (-5°F +210°F) Nitril (N)
-10°C +180°C (+15°F +356°F) FPM (V)

Max. Working Pressure - Max. Betriebsdruck

rtc 101.06	16 bar (232 PSI)
rtc 101.09	16 bar (232 PSI)
rtc 101.10	16 bar (232 PSI)
rtc 101.12	16 bar (232 PSI)
rtc 101.16	16 bar (232 PSI)
rtc 101.20	16 bar (232 PSI)
rtc 101.25	16 bar (232 PSI)
rtc 101.38	16 bar (232 PSI)

Flow size - Nennweiten

rtc 101.06	6 mm
rtc 101.09	9 mm
rtc 101.10	10 mm
rtc 101.12	12 mm
rtc 101.16	16 mm
rtc 101.20	20 mm
rtc 101.25	25 mm
rtc 101.38	38 mm



Flow Rate vs Pressure Drop Graph / Durchflussrate vs Druckabfall

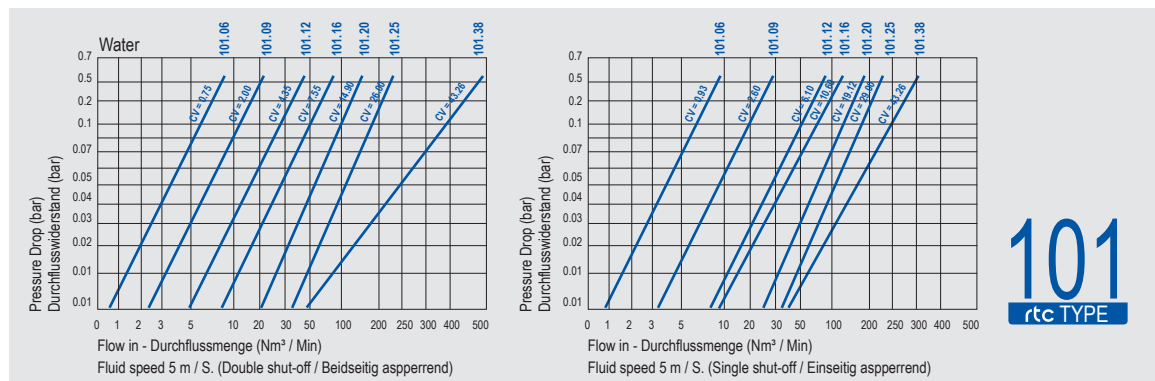

101
rtc TYPE

rtc TYPE 101

Standard hose tail socket / Kupplung mit Standard Schlauchtülle



Socket / Kupplung

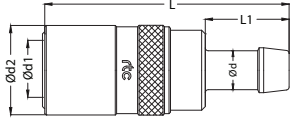

Body size Größe	Single & Double Shot-Off		Full Flow	D	D1	D2	L	L1
		Order No						
6		101.06 SHB 06		Ø 6	9.5	19	60	23
6		101.06 SHB 08		Ø 8	9.5	19	60	23
9		101.09 SHB 10		Ø 10	14	24.5	69	27.5
9		101.09 SHB 12		Ø 12	14	24.5	69	27.5
10		101.10 SHB 10		Ø 10	14.5	24.5	69	27.5
10		101.10 SHB 12		Ø 12	14.5	24.5	69	27.5
12		101.12 SHB 12		Ø 12	18	30	81.5	27.5
12		101.12 SHB 16		Ø 16	18	30	81.5	33
16		101.16 SHB 16		Ø 16	22.5	37.5	108	33
16		101.16 SHB 19		Ø 19	22.5	37.5	108	33

rtc TYPE 101

Standard hose tail socket 90° / Kupplung mit Standard Schlauchtülle 90°



Socket / Kupplung

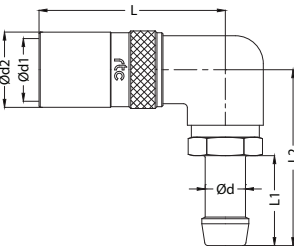

Body size Größe	Single & Double Shot-Off		Full Flow	D	D1	D2	L	L1
		Order No						
6		101.06 SHB 08 90		Ø 8	9.5	19	60	23
9		101.09 SHB 10 90		Ø 10	14	24.5	69	27.5
9		101.09 SHB 12 90		Ø 12	14	24.5	69	27.5
10		101.10 SHB 10 90		Ø 10	14.5	24.5	69	27.5
10		101.10 SHB 12 90		Ø 12	14.5	24.5	69	27.5
12		101.12 SHB 13 90		Ø 13	18	30	84	27.5
12		101.12 SHB 16 90		Ø 16	18	30	84	33
16		101.16 SHB 19 90		Ø 19	22.5	37.5	114	33

rtc TYPE 101

Push to connect hose tail socket / Kupplung mit schnellsteck Schlauchtülle



Socket / Kupplung

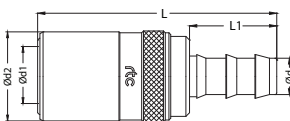

Body size Größe	Single & Double Shot-Off		Full Flow	D	D1	D2	L	L1
		Order No						
6		101.06 SPB 10		Ø 10	9.5	19	61	24
9		101.09 SPB 10		Ø 10	14	24.5	66	24
9		101.09 SPB 13		Ø 13	14	24.5	81.5	28
10		101.10 SPB 10		Ø 10	14.5	24.5	66	24
10		101.10 SPB 13		Ø 13	14.5	24.5	81.5	28
12		101.12 SPB 13		Ø 13	18	30	81.5	28
12		101.12 SPB 16		Ø 16	18	30	91.5	38
16		101.16 SPB 19		Ø 19	22.5	37.5	113	38

rtc TYPE 101

Push to connect hose tail socket 90° / Kupplung mit schnellsteck Schlauchtülle 90°



Socket / Kupplung

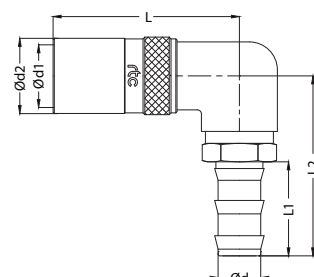





Body size Größe	Single & Double Shot-Off		Full Flow	D	D1	D2	L	L1
		Order No						
6		101.06 SPB 10 90		Ø 10	9.5	19	60	24
9		101.09 SPB 10 90		Ø 10	14	24.5	69	24
9		101.09 SPB 13 90		Ø 13	14	24.5	69	28
10		101.10 SPB 10 90		Ø 10	14.5	24.5	69	24
10		101.10 SPB 13 90		Ø 13	14.5	24.5	69	28
12		101.12 SPB 13 90		Ø 13	18	30	84	28
12		101.12 SPB 16 90		Ø 16	18	30	84	38
16		101.16 SPB 19 90		Ø 19	22.5	37.5	114	38

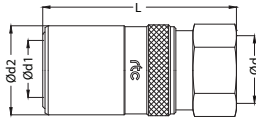

Female thread socket / Kupplung mit Innengewinde

TYPE 101 







Socket / Kupplung	Body size Größe	Single & Double Shot-Off		Full Flow	D	D1	D2	L	HEX.
									
		Order No		Order No					
	6	101.06 SFB 13	101.06 SNB 13	101.06 SFF 13	BSP 1/4	9.5	19	46	17
	6	101.06 SFB 13	101.06 SNB 13	101.06 SNF 13	NPT 1/4	9.5	19	46	17
	9	101.09 SFB 17	101.09 SNB 17	101.09 SFF 17	BSP 3/8	14	24.5	53	22
	9	101.09 SFB 17	101.09 SNB 17	101.09 SNF 17	NPT 3/8	14	24.5	53	22
	10	101.10 SFB 17	101.10 SNB 17	101.10 SFF 17	BSP 3/8	14	24.5	53	22
	10	101.10 SFB 17	101.10 SNB 17	101.10 SNF 17	NPT 3/8	14	24.5	53	22
	12	101.12 SFB 21	101.12 SNB 21	101.12 SFF 21	BSP 1/2	18	30	68	27
	12	101.12 SFB 21	101.12 SNB 21	101.12 SNF 21	NPT 1/2	18	30	68	27
	16	101.16 SFB 26	101.16 SNB 26	101.16 SFF 26	BSP 3/4	22.5	37.5	90	35
	16	-	-	101.16 SFF 26x55	BSP 3/4	22.5	37.5	55	35
	16	101.16 SNB 26	101.16 SNB 26	101.16 SNF 26	NPT 3/4	22.5	37.5	90	35

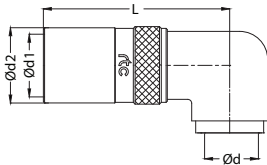

Female thread socket 90° / Kupplung mit Innengewinde 90°

TYPE 101 







Socket / Kupplung	Body size Größe	Single & Double Shot-Off		Full Flow	D	D1	D2	L	HEX.
									
		Order No		Order No					
	6	101.06 SFB 13 90	101.06 SNB 13 90	101.06 SFF 13 90	BSP 1/4	9.5	19	46	17
	6	101.06 SFB 13 90	101.06 SNB 13 90	101.06 SNF 13 90	NPT 1/4	9.5	19	46	17
	9	101.09 SFB 17 90	101.09 SNB 17 90	101.09 SFF 17 90	BSP 3/8	14	24.5	53	22
	9	101.09 SFB 17 90	101.09 SNB 17 90	101.09 SNF 17 90	NPT 3/8	14	24.5	53	22
	10	101.10 SFB 17 90	101.10 SNB 17 90	101.10 SFF 17 90	BSP 3/8	14.5	24.5	53	22
	10	101.10 SFB 17 90	101.10 SNB 17 90	101.10 SNF 17 90	NPT 3/8	14.5	24.5	53	22
	12	101.12 SFB 21 90	101.12 SNB 21 90	101.12 SFF 21 90	BSP 1/2	18	30	68	27
	12	101.12 SFB 21 90	101.12 SNB 21 90	101.12 SNF 21 90	NPT 1/2	18	30	68	27
	16	101.16 SNB 26 90	101.16 SNB 26 90	101.16 SNF 26 90	BSP 3/4	22.5	38	114	35

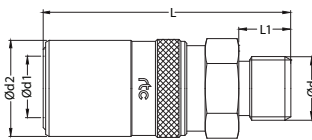

Cylindrical male thread socket / Kupplung mit zylindrischem Aussengewinde

TYPE 101 







Socket / Kupplung	Body size Größe	Single & Double Shot-Off		Full Flow	D	D1	D2	L	L1	HEX.
										
		Order No		Order No						
	6	101.06 SOB 13	101.06 SNB 13	101.06 SOF 13	BSP 1/4	9.5	19	46	10	17
	9	101.09 SOB 17	101.09 SNB 17	101.09 SOF 17	BSP 3/8	14	24.5	53	11	22
	10	101.10 SOB 17	101.10 SNB 17	101.10 SOF 17	BSP 3/8	14.5	24.5	53	11	22
	12	101.12 SOB 21	101.12 SNB 21	101.12 SOF 21	BSP 1/2	18	30	67	14	27
	16	101.16 SOB 26	101.16 SNB 26	101.16 SOF 26	BSP 3/4	22.5	37.5	90.5	14	35

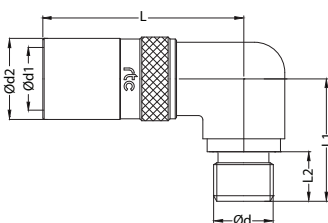

Male thread socket 90° / Kupplung mit Aussengewinde 90°

TYPE 101 



Socket / Kupplung	Body size Größe	Single & Double Shot-Off		Full Flow	D	D1	D2	L	L1	L2	HEX.
											
		Order No		Order No							
	6	101.06 SOB 13 90	101.06 SNB 13 90	101.06 SOF 13 90	BSP 1/4	9.5	19	46	34	9	17
	9	101.09 SOB 17 90	101.09 SNB 17 90	101.09 SOF 17 90	BSP 3/8	14	24.5	53	40	10	22
	10	101.10 SOB 17 90	101.10 SNB 17 90	101.10 SOF 17 90	BSP 3/8	14.5	24.5	53	40	10	22
	12	101.12 SOB 21 90	101.12 SNB 21 90	101.12 SOF 21 90	BSP 1/2	18	30	67	47	12	37
	16	101.16 SOB 26 90	101.16 SNB 26 90	101.16 SOF 26 90	BSP 3/4	22.5	37.5	114	53	19	35

rtc TYPE 101

Conical male thread plug inner hex / Nippel mit konischem Aussengewinde und Innensechskant



Plugs / Nippel	Body size Größe	Full Flow Order No	D	L	L1	INNER HEX.
	6	101.06 PRF 10	BSPT 1/8	31	7.5	5
	6	101.06 PRF 13	BSPT 1/4	35	13	5
	6	101.06 PTF 10	NPT 1/8	31	10	5
	6	101.06 PTF 13	NPT 1/4	35	13	5
	9	101.09 PRF 13	BSPT 1/4	34	10	8
	9	101.09 PRF 17	BSPT 3/8	36	11	8
	9	101.09 PTF 13	NPT 1/4	34	11	8
	9	101.09 PTF 17	NPT 3/8	36	11	8
	10	101.10 PRF 17	BSPT 3/8	36	11	8
	10	101.10 PTF 17	NPT 3/8	36	11	8
	12	101.12 PRF 17	BSPT 3/8	39	13	10

rtc TYPE 101

Conical male thread plug / Nippel mit konischem Aussengewinde



Plugs / Nippel	Body size Größe	Full Flow Order No	D	L	L1	HEX.
	12	101.12 PTF 17	NPT 3/8	41	13	24
	12	101.12 PRF 21	BSPT 1/2	44	16	22
	12	101.12 PTF 21	NPT 1/2	44	16	22
	16	101.16 PRF 26	BSPT 3/4	63	16.5	27

rtc TYPE 101

Cylindrical male thread plug / Nippel mit zylindrischem Aussengewinde



Plugs / Nippel	Body size Größe	Full Flow Order No	D	L	L1	HEX.
	6	101.06 PMF 17	BSP 3/8	35.5	10	19
	9	101.09 PMF 21	BSP 1/2	37	12	22
	10	101.10 PMF 21	BSP 1/2	37	12	22
	12	101.12 PMF 26	BSP 3/4	46	16	27
	16	101.16 PMF 33	BSP 1	60	22	32
	16	101.16 PMF 2415	M24x1.5	60	22	27

rtc TYPE 101

Female thread plug / Nippel mit Innengewinde



Plugs / Nippel	Body size Größe	Full Flow Order No	D	L	HEX.
	6	101.06 PFF 13	BSP 1/4	34	17
	6	101.06 PNF 13	NPT 1/4	47	17
	9	101.09 PFF 13	BSP 1/4	37	22
	9	101.09 PNF 13	NPT 1/4	49	22
	9	101.09 PFF 17	BSP 3/8	47	22
	9	101.09 PNF 17	NPT 3/8	49	22
	10	101.10 PFF 17	BSP 3/8	47	22
	10	101.10 PNF 17	NPT 3/8	49	22
	12	101.12 PFF 21	BSP 1/2	45	27
	12	101.12 PNF 21	NPT 1/2	67	27
	16	101.16 PFF 26	BSP 3/4	58	32
	16	101.16 PNF 26	NPT 3/4	80	32

rtc TYPE 101

Standard hose tail plug / Nippel mit gerader Standard - Schlauchfülle



Plugs / Nippel	Body size Größe	Full Flow Order No	ØD	L	L1
	6	101.06 PHF 08	Ø 8	44	23
	9	101.09 PHF 12	Ø 12	50	27.5
	10	101.10 PHF 12	Ø 12	50	27.5
	12	101.12 PHF 16	Ø 16	62	33
	16	101.16 PHF 19	Ø 19	70	33



Cylindrical male thread shut-off plug with sealing O-Ring / Verschlussnippel mit zylindrischem Aussengewinde und O-Ring

TYPE 101



Plugs / Nippel

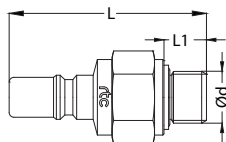

Body size Größe	Single & Double Shot-Off		D	L	L1	HEX.
	Order No	Order No				
6	101.06 POB 10	101.06 POB 10	BSP 1/8	45	7	17
6	101.06 POB 13	101.06 POB 13	BSP 1/4	45	9	17
9	101.09 POB 13	101.09 POB 13	BSP 1/4	51	9	19
9	101.09 POB 17	101.09 POB 17	BSP 3/8	48	10	20
10	101.10 POB 17	101.10 POB 17	BSP 3/8	48	10	20
12	101.12 POB 17	101.12 POB 17	BSP 3/8	63.5	10	24
12	101.12 POB 21	101.12 POB 21	BSP 1/2	62	12	24
16	101.16 POB 26	101.16 POB 26	BSP 3/4	81	14	32



Conical male thread plug with valve / Verschlussnippel mit konischem Aussengewinde

TYPE 101



Plugs / Nippel

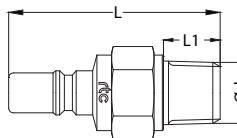

Body size Größe	Single & Double Shot-Off		D	L	L1	HEX.
	Order No	Order No				
6	101.06 PTB 10	101.06 PTB 10	NPT 1/8	45	10	17
6	101.06 PTB 13	101.06 PTB 13	NPT 1/4	45	11	17
9	101.09 PTB 13	101.09 PTB 13	NPT 1/4	52	13	19
9	101.09 PTB 17	101.09 PTB 17	NPT 3/8	48.5	13	19
10	101.10 PTB 17	101.10 PTB 17	NPT 3/8	48.5	13	19
12	101.12 PTB 17	101.12 PTB 17	NPT 3/8	62	13	24
12	101.12 PTB 21	101.12 PTB 21	NPT 1/2	62	15	24
16	101.16 PTB 26	101.16 PTB 26	NPT 3/4	81	19	32



Female thread plug with valve / Verschlussnippel mit Innengewinde

TYPE 101



Plugs / Nippel

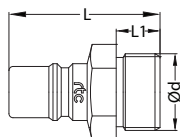

Body size Größe	Order No	ØD	L	L1	HEX.
6	101.06 PMB 17	BSP 3/8	35.5	10	19
9	101.09 PMB 21	BSP 1/2	37	12	22
10	101.09 PMB 21	BSP 1/2	37	12	22
12	101.12 PMB 26	BSP 3/4	46	16	27
16	101.16 PMB 33	BSP 1	62	24	32



Female thread plug with valve / Verschlussnippel mit Innengewinde

TYPE 101



Plugs / Nippel

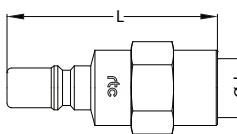

Body size Größe	Single & Double Shot-Off		D	L	HEX.
	Order No	Order No			
6	101.06 PFB 13	101.06 PFB 13	BSP 1/4	47	17
6	101.06 PNB 13	101.06 PNB 13	NPT 1/4	47	17
9	101.09 PFB 13	101.09 PFB 13	BSP 1/4	48.5	22
9	101.09 PNB 13	101.09 PNB 13	NPT 1/4	48.5	22
9	101.09 PFB 17	101.09 PFB 17	BSP 3/8	49	22
9	101.09 PNB 17	101.09 PNB 17	NPT 3/8	49	22
10	101.10 PFB 17	101.10 PFB 17	BSP 3/8	49	22
10	101.10 PNB 17	101.10 PNB 17	NPT 3/8	49	22
12	101.12 PFB 21	101.12 PFB 21	BSP 1/2	63	27
12	101.12 PNB 21	101.12 PNB 21	NPT 1/2	65	27
16	101.16 PFB 26	101.16 PFB 26	BSP 3/4	81	32
16	101.16 PNB 26	101.16 PNB 26	NPT 3/4	81	32

rtc TYPE 101

Installation of conical male thread plug / Nippel mit konischem Aussengewinde für den versenkten Einbau



Plugs / Nippel

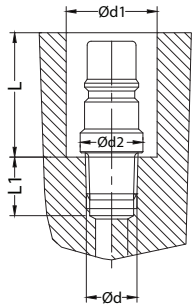

Body size Größe	Order No	D	D1	D2	L	L1	INNER HEX.
6	101.06 PRF 10	BSPT 1/8	20	10	26	9	5
6	101.06 PTF 10	NPT 1/8	20	11	28	9	5
6	101.06 PRF 13	BSPT 1/4	20	14	27	12	5
6	101.06 PTF 13	NPT 1/4	20	14	27	13	5
9	101.09 PRF 13	BSPT 1/4	26	14	26	12	8
9	101.09 PTF 13	NPT 1/4	26	14	26	13	8
9	101.09 PRF 17	BSPT 3/8	26	17	28	13	8
9	101.09 PTF 17	NPT 3/8	26	17	28	13	8
10	101.10 PRF 17	BSPT 3/8	26	17	28	13	8
10	101.10 PTF 17	NPT 3/8	26	17	28	13	8
12	101.12 PRF 17	BSPT 3/8	33	18	31	13	10

rtc TYPE 101

Installation of conical male thread plug / Nippel mit konischem Aussengewinde für den versenkten Einbau



Plugs / Nippel

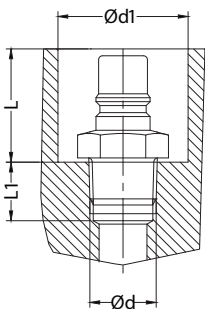

Body size Größe	Order No	D	D1	L	L1	HEX.
12	101.12 PTF 17	NPT 3/8	36	29	11	24
12	101.12 PRF 21	BSPT 1/2	33	29	15	22
12	101.12 PTF 21	NPT 1/2	33	29	15	22
16	101.16 PRF 26	BSPT 3/4	40	47	19	27



Installation of male thread plug with valve / Verschlussnippel mit Aussengewinde für den versenkten Einbau

TYPE 101



Plugs / Nippel

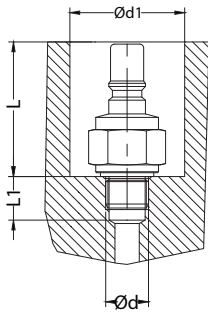

Body size Größe	Single & Double Shot-Off		D	L	D1	L1	HEX.
		Order No					
6		101.06 POB 10	BSP 1/8	33	26	9	17
6		101.06 POB 13	BSP 1/4	33	26	12	17
9		101.09 POB 13	BSP 1/4	38.5	29	12	19
9		101.09 POB 17	BSP 3/8	38.5	30	13	20
10		101.10 POB 17	BSP 3/8	38.5	30	13	20
12		101.12 POB 17	BSP 3/8	46.5	36	13	24
12		101.12 POB 21	BSP 1/2	46.5	36	15	24
16		101.16 POB 26	BSP 3/4	67	46	16	32



Installation of con. male thread plug with valve / Verschlussnippel mit kon. Aussengewinde für den versenkten Einbau

TYPE 101



Plugs / & Nippel

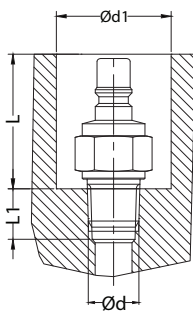

Body size Größe	Single & Double Shot-Off		D	L	D1	L1	HEX.
		Order No					
6		101.06 PTB 10	NPT 1/8	33	26	9	17
6		101.06 PTB 13	NPT 1/4	33	26	12	17
9		101.09 PTB 13	NPT 1/4	38.5	29	12	19
9		101.09 PTB 17	NPT 3/8	38.5	30	13	20
10		101.10 PTB 17	NPT 3/8	38.5	30	13	20
12		101.12 PTB 17	NPT 3/8	46.5	36	13	24
12		101.12 PTB 21	NPT 1/2	46.5	36	15	24
16		101.16 PTB 26	NPT 3/4	67	46	16	32

rtc TYPE 101

Cylindrical female thread socket / Kupplung mit Innengewinde zylindrisch



Socket / Kuplungen

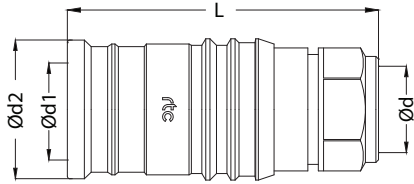

Body size Größe	Single & Double Shot-Off		ØD	ØD1	ØD2	L	HEX.
	Order No	Order No					
20	101.20 SFB 26		BSP 3/4	31	53	119	42
20	101.20 SFB 33		BSP 1	31	54	119	42
20	101.20 SNB 33		NPT 1	31	53	119	42
25	101.25 SFB 33		BSP 1	36	59.5	141	50
25	101.25 SFB 42		BSP 1-1/4	36	59.5	141	50
25	101.25 SNB 42		NPT 1-1/4	36	59.5	141	50
38	101.38 SFB 60		BSP 2	49	80	150	70
38	101.38 SNB 60		NPT 2	49	80	150	70

rtc TYPE 101

Cylindrical male thread socket / Kupplung mit Aussengewinde zylindrisch



Socket / Kuplungen

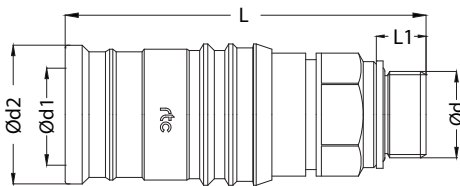

Body size Größe	Single & Double Shot-Off		ØD	ØD1	ØD2	L	L1	HEX.
	Order No	Order No						
20	101.20 SOB 33		BSP 1	31	54	133	19	42
25	101.25 SOB 33		BSP 1	36	59.5	142	19	50
25	101.25 SOB 42		BSP 1-1/4	36	59.5	142	19	50
38	101.38 SOB 48		BSP 1-1/2	49	80	167	19	70
38	101.38 SOB 60		BSP 2	49	80	171	25	70

rtc TYPE 101

NPT male thread socket / Kupplung mit Aussengewinde NPT



Socket / Kuplungen

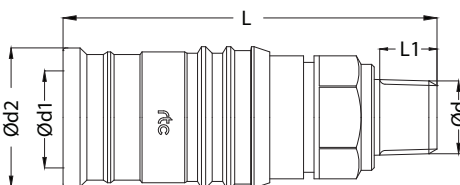

Body size Größe	Single & Double Shot-Off		ØD	ØD1	ØD2	L	L1	HEX.
	Order No	Order No						
20	101.20 STB 33		NPT 1	31	54	136	22	42
25	101.25 STB 42		NPT 1-1/4	36	59.5	145	24.5	50
38	101.38 STB 48		NPT 1-1/2	49	80	172	24.5	70
38	101.38 STB 60		NPT 2	49	80	174	25.5	70



Cylindrical female thread plug with valve / Verschlussnippel mit Innengewinde zylindrisch

TYPE 101 **rtc**

Plugs / Nippel	Body size Größe	Single & Double Shot-Off		ØD	L	HEX.
		Order No				
	20	101.20 PFB 26		BSP 3/4	126.5	42
	20	101.20 PFB 33		BSP 1	126.5	42
	20	101.20 PNB 33		NPT 1	126.5	42
	25	101.25 PFB 33		BSP 1	148.5	50
	25	101.25 PFB 42		BSP 1-1/4	148.5	50
	25	101.25 PNB 42		NPT 1-1/4	148.5	50
	38	101.38 PFB 48		BSP 1-1/2	156	70
	38	101.38 PFB 60		BSP 2	156	70



NPT male thread plug with valve / Verschlussnippel mit Aussengewinde NPT

TYPE 101 **rtc**

Plugs / Nippel	Body size Größe	Single & Double Shot-Off		ØD	L	L1	HEX.
		Order No					
	20	101.20 PMB 33		BSP 1	141	19	42
	25	101.25 PMB 48		BSP 1-1/2	151	19	50



NPT male thread plug with valve / Verschlussnippel mit Aussengewinde NPT

TYPE 101 **rtc**

Plugs / Nippel	Body size Größe	Single & Double Shot-Off		ØD	L	L1	HEX.
		Order No					
	20	101.20 PTB 33		NPT 1	146	24	42
	25	101.25 PTB 48		NPT 1-1/2	156	24	50



Cylindrical female thread plug / Nippel mit Innengewinde zylindrisch

TYPE 101 **rtc**

Plugs / Nippel	Body size Größe	Order No	ØD	L	HEX.
25	101.25 PFF 48	BSP 1-1/2	100	55	