

rtc[®]

QUICK CONNECT TECHNOLOGY
www.rtc-tec.com



152

rtc TYPE



Temperature Range - Temperaturbereich
 -20°C +100°C (-4°F +212°F) Nitril (N)
 -10°C +200°C (+14°F +392°F) FPM (V)

Max. Working Pressure - Max. Betriebsdruck
 rtc 152.10 16 bar (232 PSI)
 rtc 152.12 16 bar (232 PSI)
 rtc 152.16 16 bar (232 PSI)
 rtc 152.20 16 bar (232 PSI)
 rtc 152.25 16 bar (232 PSI)

Flow size - Nennweiten
 rtc 152.10 10 mm
 rtc 152.12 12 mm
 rtc 152.16 16 mm
 rtc 152.20 20 mm
 rtc 152.25 25 mm

Material
 Socket Body - Kupplungsgrundkörper Brass - Messing
 Sleeve - Hülse Stainless Steel - Edelstahl
 Valve - Ventil Brass - Messing
 Locking Ring - Sprengring Stainless Steel - Edelstahl
 Balls - Kugeln Stainless Steel - Edelstahl
 Seals - Dichtungen FKM (V)
 Plug - Nippel Stainless Steel - Edelstahl
 Back part Nippel - Nippel Hinterteil Brass - Messing

Standard version - Standardversion
 FPM (V)
 Leakage free design
 Special designed valve for high flow rate.

Options - Optionen
E EPDM Seal - EPDM Dichtung
W FFKM Seal - FFKM Dichtung

Using Area
 - On temperature regulation applications with hot or cold water, oil etc.
 - Blow moulding industry
 - Injection moulding industries.
 - On steam line.

Anwendungsbereiche
 - Zuleitung für die Temperierung / Druckluft
 - Blasformmaschinen Industrie
 - Kühlung mit Öl oder Wasser
 - Kunststoffindustrie



Flow Rate vs Pressure Drop Graph / Durchflussrate vs Druckabfall

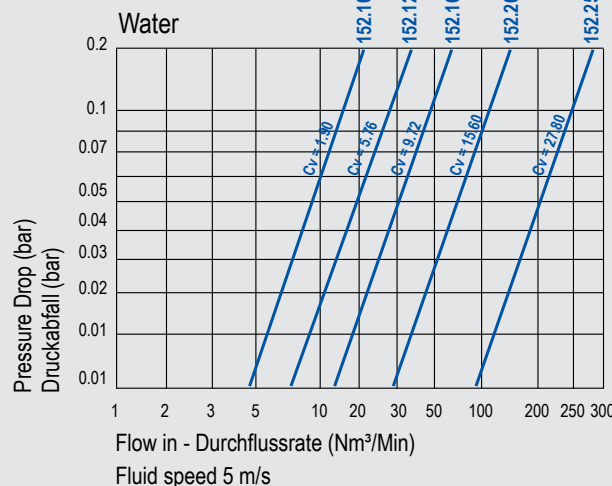

152
rtc TYPE

rtc TYPE 152

Female thread socket / Kupplung mit Innengewinde



Socket / Kupplung

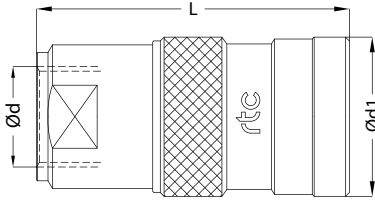

Size Größe	Order No / Bestellnr.	Ød	Ød1	L	HEX.
10	152.10 SFB 17	BSP 3/8	29	54	25
10	152.10 SNB 17	NPT 3/8	29	54	25
12	152.12 SFB 21	BSP 1/2	30	54	25
12	152.12 SNB 21	NPT 1/2	30	54	25
16	152.16 SFB 26	BSP 3/4	42	82.5	32
16	152.16 SNB 26	NPT 3/4	42	82.5	32
20	152.20 SFB 33	BSP 1	54	116	41
20	152.20 SNB 33	NPT 1	54	116	41
25	152.25 SFB 33	BSP 1	62	122.5	50
25	152.25 SNB 33	NPT 1	62	122.5	50
25	152.25 SFB 42	BSP 1-1/4	62	122.5	50
25	152.25 SNB 42	NPT 1-1/4	62	122.5	50

rtc TYPE 152

Male thread socket / Kupplung mit Aussengewinde



Socket / Kupplung

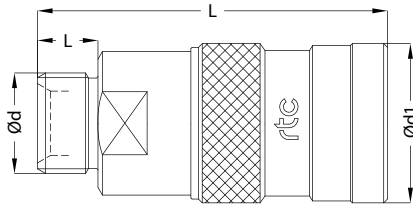

Size Größe	Order No / Bestellnr.	Ød	Ød1	L	L1	HEX.
10	152.10 SMB 17	BSP 3/8	29	51.5	11	25
10	152.10 SMB 21	BSP 1/2	29	52.5	12	25
12	152.12 SMB 21	BSP 1/2	30	61.5	12	25
16	152.16 SMB 26	BSP 3/4	42	82.5	16	32
20	152.20 SMB 33	BSP 1	54	118	19	41
25	152.25 SMB 33	BSP 1	62	130.5	19	50
25	152.25 SMB 42	BSP 1-1/4	62	130.5	19	50

rtc TYPE 152

Standard hose tail socket / Kupplung mit Standard Schlauchtülle



Socket / Kupplung

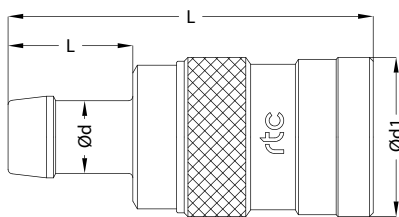

Size Größe	Order No / Bestellnr.	Ød	Ød1	L	L1
10	152.10 SHB 10	10	29	65	23
10	152.10 SHB 12	12	29	69	27.5
12	152.12 SHB 12	12	30	69	27.5
12	152.12 SHB 16	16	30	69	27.5
16	152.16 SHB 16	16	42	99	27.5
16	152.16 SHB 19	19	42	104.5	33

rtc TYPE 152

Push to connect hose tail socket / Kupplung mit Schnellsteck Schlauchtülle



Socket / Kupplung

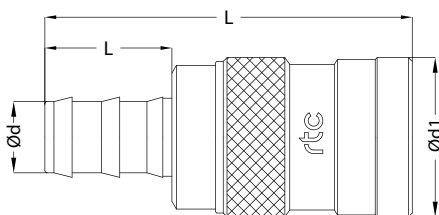

Size Größe	Order No / Bestellnr.	Ød	Ød1	L	L1
10	152.10 SPB 10	10	29	66	24
10	152.10 SPB 13	13	29	70	28
12	152.12 SPB 13	13	30	70	28
12	152.12 SPB 16	16	30	70	28
16	152.16 SPB 16	16	42	99.5	28
16	152.16 SPB 19	19	42	109.5	38



Cylindrical female thread plug / Nippel mit Innengewinde zylindrisch

TYPE 152 **rtc**

Plug / Nippel	Size Größe	Order No / Bestellnr.	Ød	Ød1	L	HEX.
	10	152.10 PFB 17	BSP 3/8	17.6	63.5	25
	10	152.10 PNB 17	NPT 3/8	17.6	62	25
	12	152.12 PFB 21	BSP 1/2	19.5	65	25
	12	152.12 PNB 21	NPT 1/2	19.5	64	25
	16	152.16 PFB 26	BSP 3/4	26.6	80	32
	16	152.16 PNB 26	NPT 3/4	26.6	80	32
	20	152.20 PFB 33	BSP 1	34	98	41
	20	152.20 PNB 33	NPT 1	34	97	41
	25	152.25 PFB 33	BSP 1	39	99	50
	25	152.25 PNB 33	NPT 1	39	98	50
	25	152.25 PFB 42	BSP 1-1/4	39	99	50
	25	152.25 PNB 42	NPT 1-1/4	39	98	50



Cylindrical Male thread plug / Nippel mit Aussengewinde zylindrisch

TYPE 152 **rtc**

Plug / Nippel	Size Größe	Order No / Bestellnr.	Ød	Ød1	L	L1	HEX.
	10	152.10 PMB 17	BSP 3/8	17.6	60	10	25
	10	152.10 PMB 21	BSP 1/2	17.6	62	12	25
	12	152.12 PMB 21	BSP 1/2	19.5	72.5	12	25
	16	152.16 PMB 26	BSP 3/4	26.6	82.5	16	32
	20	152.20 PMB 33	BSP 1	34	105	19	41
	25	152.25 PMB 33	BSP 1	39	106	19	50
	25	152.25 PMB 42	BSP 1-1/4	39	106	19	50



Standard hose tail plug / Nippel mit Standard Schlauchtülle

TYPE 152 **rtc**

Socket / Kupplung	Size Größe	Order No / Bestellnr.	Ød	Ød1	L	L1
	10	152.10 PHB 10	10	17.6	73	23
	10	152.10 PHB 12	12	17.6	77.5	27.5
	12	152.12 PHB 12	12	19.5	80.5	27.5
	12	152.12 PHB 16	16	19.5	80.5	27.5
	16	152.16 PHB 16	16	26.6	90	27.5
	16	152.16 PHB 19	19	26.6	95.5	33



Push to connect hose tail plug / Nippel mit Schnellsteck Schlauchtülle

TYPE 152 **rtc**

Socket / Kupplung	Size Größe	Order No / Bestellnr.	Ød	Ød1	L	L1
	10	152.10 PPB 10	10	17.6	74	24
	10	152.10 PPB 13	13	17.6	78	28
	12	152.12 PPB 13	13	19.5	81	28
	12	152.12 PPB 16	16	19.5	81	28
	16	152.16 PPB 16	19	26.6	90.5	28
	16	152.16 PPB 19	19	26.6	100.5	38