

rtc[®]

QUICK CONNECT TECHNOLOGY

www.rtc-tec.com



035

rtc TYPE



DN 7.4 mm Pneumatic Breathing Air Coupling

TYPE 035



Compatible - Kompatibilität

Rectus 95KS
Cejn 344

Temperature Range - Temperaturbereich

Nitrile (N) -20°C + 100°C (- 4°F + 212°F)
FPM (V) -20°C + 180°C (- 4°F + 356°F)
EPDM (Ethylene Propylene) -40°C + 150°C (- 40°F + 302°F)

Working Pressure - Betriebsdruck

35 Bar (510 PSI)

Flow size - Nennweite

rtc type 035 7.4 mm

Standard version - Standardversion

Seals - Dichtung : Nitrile (N)

Material of Standard Coupler

Material für die Standardversion

Socket body - Kupplungsgrundkörper	Brass Nickel Plated - Messing vernickelt
Sleeve - Hülse	Brass Nickel Plated - Messing vernickelt
Springs - Federn	Stainless Steel - Edelstahl
Locking Ring - Sprenging	Stainless Steel - Edelstahl
Balls - Kugeln	Stainless Steel - Edelstahl

Plug - Nippel	Brass Nickel Plated - Messing vernickelt
------------------	---

Technical Specifications & Advantages

- Sister coupling of rtc type 036.
- Safety feature of the coupling is the plug should be pushed more into the coupling in order to disconnect.
- Breathing air coupling
- Advantage of one hand useage.
- High performance valve with increased flow rate and minimised pressure loss.
- Anti-corrosive
- One hand operation



Flow Rate vs Pressure Drop Graph

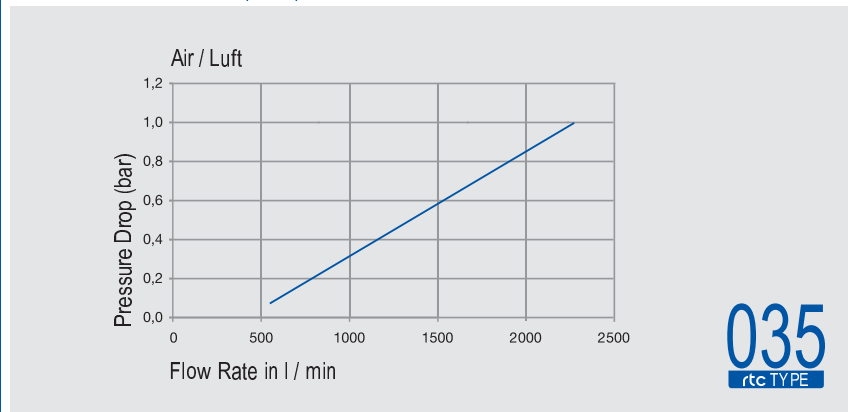

035
rtc TYPE

rtc TYPE 035

Male Thread / Aussengewinde



Sockets / Kupplungen

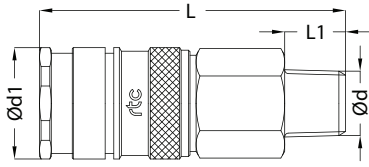

Size / Grosse	Order No / Bestellnr.	Ød	Ød1	L	L1	HEX.
7.4	035 SMO 13	BSP 1/4	22	57	9	19
7.4	035 SMO 17	BSP 3/8	22	57	11	19
7.4	035 SMO 21	BSP 1/2	22	52	12	22
7.4	035 SRO 10	BSPT 1/8	22	57	9	19
7.4	035 SRO 13	BSPT 1/4	22	60	12	19
7.4	035 SRO 17	BSPT 3/8	22	59	12	19
7.4	035 SRO 21	BSPT 1/2	22	57	17	22
7.4	035 STO 13	NPT 1/4	22	60	12	19
7.4	035 STO 17	NPT 3/8	22	59	12	19
7.4	035 STO 21	NPT 1/2	22	57	17	22

rtc TYPE 035

Female Thread / Innengewinde



Sockets / Kupplungen

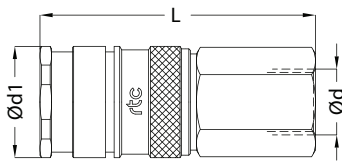

Size / Grosse	Order No / Bestellnr.	Ød	Ød1	L	HEX.
7.4	035 SFO 13	BSP 1/4	22	55	19
7.4	035 SFO 17	BSP 3/8	22	54	19
7.4	035 SFO 21	BSP 1/2	22	57	24
7.4	035 SNO 13	NPT 1/4	22	58	19
7.4	035 SNO 17	NPT 3/8	22	58	19
7.4	035 SNO 21	NPT 1/2	22	62	24

rtc TYPE 035

Hose Barb / Schlauchanschluss



Sockets / Kupplungen

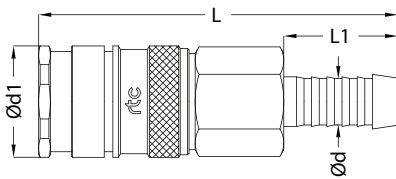

Size / Grosse	Order No / Bestellnr.	Ød	Ød1	L	L1
7.4	035 SHO 06	6 mm	22	71	23
7.4	035 SHO 08	8 mm	22	71	23
7.4	035 SHO 09	9 mm	22	71	23
7.4	035 SHO 10	10 mm	22	71	23
7.4	035 SHO 13	13 mm	22	71	23

Male Thread / Aussengewinde TYPE 035 **rtc**

Plugs / Nippel	Size / Grosse	Order No / Bestellnr.	Ød	Ød1	L	L1	HEX.
	7.4	035 PMF 13	BSP 1/4	10	37	11	17
	7.4	035 PMF 17	BSP 3/8	10	39	11	19
	7.4	035 PRF 13	BSPT 1/4	10	38	12	17
	7.4	035 PRF 17	BSPT 3/8	10	40	12	17
	7.4	035 PRF 21	BSPT 1/2	10	47	17	22
	7.4	035 PTF 13	NPT 1/4	10	38	12	17

Female Thread / Innengewinde TYPE 035 **rtc**

Plugs / Nippel	Size / Grosse	Order No / Bestellnr.	Ød	Ød1	L	HEX.
	7.4	035 PFF 13	BSP 1/4	10	37	17
	7.4	035 PFF 17	BSP 3/8	10	39	19

Hose Barb / Schlauchanschluss TYPE 035 **rtc**

Plugs / Nippel	Size / Grosse	Order No / Bestellnr.	Ød	Ød1	L	L1
	7.4	035 PHF 06	6 mm	10	46	23
	7.4	035 PHF 08	8 mm	10	46	23
	7.4	035 PHF 09	9 mm	10	46	23
	7.4	035 PHF 10	10 mm	10	46	23
	7.4	035 PHF 13	13 mm	10	46	23

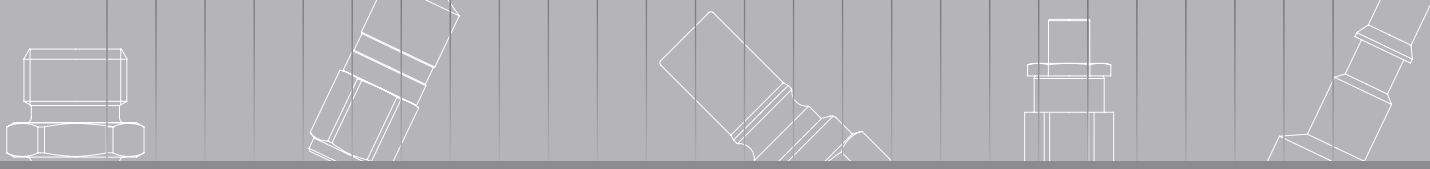

rtc[®]

QUICK CONNECT TECHNOLOGY

www.rtc-tec.com



036

rtc TYPE



DN 7.4 mm Pneumatic Breathing Air Coupling

TYPE 036



Compatible - Kompatibilität

Rectus 96KS
Cejn 342

Temperature Range - Temperaturbereich

Nitrile (N) -20°C + 100°C (- 4°F + 212°F)
FPM (V) -20°C + 180°C (- 4°F + 356°F)
EPDM (Ethylene Propylene) -40°C + 150°C (- 40°F + 302°F)

Working Pressure - Betriebsdruck

35 Bar (510 PSI)

Flow size - Nennweite

rtc type 036 7.4 mm

Standard version - Standardversion

Seals - Dichtung : Nitrile (N)

Material of Standard Coupler

Material für die Standardversion

Socket body - Kupplungsgrundkörper	Brass Nickel Plated - Messing vernickelt
Sleeve - Hülse	Brass Nickel Plated - Messing vernickelt
Springs - Federn	Stainless Steel - Edelstahl
Locking Ring - Sprenging	Stainless Steel - Edelstahl
Balls - Kugeln	Stainless Steel - Edelstahl

Plug - Nippel	Brass Nickel Plated - Messing vernickelt
------------------	---

Technical Specifications & Advantages

- Sister coupling of rtc type 035.
- Safety feature of the coupling is the plug should be pushed more into the coupling in order to disconnect.
- Breathing air coupling
- Advantage of one hand useage.
- High performance valve with increased flow rate and minimised pressure loss.
- Anti-corrosive
- One hand operation



Flow Rate vs Pressure Drop Graph

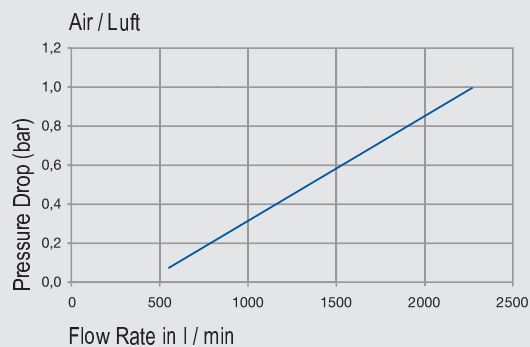

036
rtc TYPE

rtc TYPE 036

Male Thread / Aussengewinde



Sockets / Kupplungen

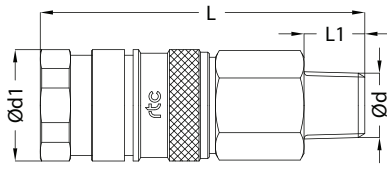

Size / Grösse	Order No / Bestellnr.	Ød	Ød1	L	L1	HEX.
7.4	036 SMO 13	BSP 1/4	22	61	9	19
7.4	036 SMO 17	BSP 3/8	22	61	11	19
7.4	036 SMO 21	BSP 1/2	22	56	12	22
7.4	036 SRO 10	BSPT 1/8	22	61	9	19
7.4	036 SRO 13	BSPT 1/4	22	64	12	19
7.4	036 SRO 17	BSPT 3/8	22	63	12	19
7.4	036 SRO 21	BSPT 1/2	22	61	17	22
7.4	036 STO 13	NPT 1/4	22	64	12	19
7.4	036 STO 17	NPT 3/8	22	63	12	19
7.4	036 STO 21	NPT 1/2	22	61	17	22

rtc TYPE 036

Female Thread / Innengewinde



Sockets / Kupplungen

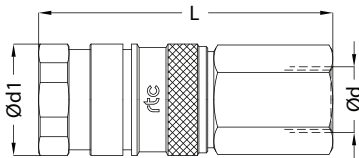

Size / Grösse	Order No / Bestellnr.	Ød	Ød1	L	HEX.
7.4	036 SFO 13	BSP 1/4	22	59	19
7.4	036 SFO 17	BSP 3/8	22	58	19
7.4	036 SFO 21	BSP 1/2	22	61	24
7.4	036 SNO 13	NPT 1/4	22	62	19
7.4	036 SNO 17	NPT 3/8	22	62	19
7.4	036 SNO 21	NPT 1/2	22	66	24

rtc TYPE 036

Hose Barb / Schlauchanschluss



Sockets / Kupplungen

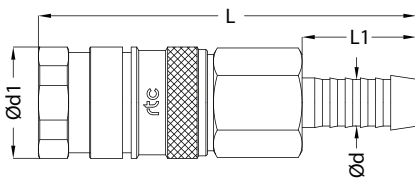

Size / Grösse	Order No / Bestellnr.	Ød	Ød1	L	L1
7.4	036 SHO 06	6 mm	22	75	23
7.4	036 SHO 07	8 mm	22	75	23
7.4	036 SHO 09	9 mm	22	75	23
7.4	036 SHO 10	10 mm	22	75	23
7.4	036 SHO 13	13 mm	22	75	23

Male Thread / Aussengewinde TYPE 036 **rtc**

Plugs / Nippel	Size / Grosse	Order No / Bestellnr.	Ød	Ød1	L	L1	HEX.
	7.4	036 PMF 13	BSP 1/4	10	42	11	17
	7.4	036 PMF 17	BSP 3/8	10	44	11	19
	7.4	036 PRF 13	BSPT 1/4	10	43	12	17
	7.4	036 PRF 17	BSPT 3/8	10	45	12	17
	7.4	036 PRF 21	BSPT 1/2	10	52	17	22
	7.4	036 PTF 13	NPT 1/4	10	43	12	17

Female Thread / Innengewinde TYPE 036 **rtc**

Plugs / Nippel	Size / Grosse	Order No / Bestellnr.	Ød	Ød1	L	HEX.
	7.4	036 PFF 13	BSP 1/4	10	42	17
	7.4	036 PFF 17	BSP 3/8	10	44	19

Hose Barb / Schlauchanschluss TYPE 036 **rtc**

Plugs / Nippel	Size / Grosse	Order No / Bestellnr.	Ød	Ød1	L	L1
	7.4	036 PHF 06	6 mm	10	51	23
	7.4	036 PHF 08	8 mm	10	51	23
	7.4	036 PHF 09	9 mm	10	51	23
	7.4	036 PHF 10	10 mm	10	51	23
	7.4	036 PHF 13	13 mm	10	51	23